



Large Character Ink Jet

# Videojet® 2300 Line

The 2300 Line of large character printers deliver high quality codes on cases and cartons, helping to reduce costs associated with pre-printed cases and labels.

The Videojet 2300 Line of large character ink jet printers are ideal for printing variable information such as bar codes, dates, ingredients, logos and graphics on cases and shipping cartons. Combining high resolution printing with a simple user interface, these printers make message selection and printing quick, easy and virtually error-free. The 2300 Line printers deliver high resolution text, bar codes, and logos up to 2.8" for a pre-printed look. Offering true generic case coding opportunity, they help eliminate excess inventory of pre-printed boxes and labels and their related expense.



## Uptime Advantage

- Consistent print quality from patented micropurge process – even in dusty environments
- Innovative technology sustains superior print quality, without affecting production speed or throughput
- Robust rounded front plate protects the printhead from case strikes on the production line, helping to ensure reliable coding

## Built-in productivity

- Micropurge feature minimizes need for operator intervention, allowing personnel to focus on other critical production tasks
- Replace pre-printed cases and labels and print variable information including bar codes, graphics and text on-line
- 180 dpi resolution allows for complete generic case coding at pre-printed quality

## Code Assurance

- Videojet CLARiTY™ interface helps get the right code in the right place on the right product, time after time
- Simple, intuitive software reduces the potential for operator errors
- Easily set message parameters and limit operators to pre-specified data ranges to help avoid errors

## Simple usability

- Single, compact unit that takes up minimal space on your packaging line
- Intuitive touch screen control makes it easy for operators to select and print the right job
- Multiple printers can be operated from a single master unit, or can be controlled remotely from a central location

# Videojet 2300 Line

## Large Character Ink Jet printing

### Print Speed

Bar code printing – 0.3 - 66 mpm (1.0 to 216 feet/min.)

Alphanumeric text – up to 132 mpm (433 feet/min.)

*Speeds are density dependent*

### Print Distance

0.5 mm to 4.0 mm max. (0.02 - 0.15")

### Print Area (per printhead)

2340: 17 mm (H) x 2000 mm (L) (0.7" x 78"), 180 dpi

2350: 53 mm (H) x 2000 mm (L) (2.1" x 78"), 180 dpi

2360: 70 mm (H) x 2000 mm (L) (2.8" x 78"), 180 dpi

### Bar Codes

PTI compliant, GS1-128, ITF-14 (UCC case code), SSCC-18, EAN13, UPC-A, UPC-E, EAN8, DataMatrix, Code 128, I 2 of 5, Code 39, others as required

### Operator Interface

Full-color 5.7" LCD touch-panel Videojet CLARiTY™ interface

Job selection and database support as standard

WYSIWYG print preview

Code Assurance

On-board diagnostics

### Graphics, Images and Logos

Multiple graphic formats supported using CLARiSOFT®

### Printing Capabilities

CLARiSOFT® Package Coding Design Software

Full downloadable font support for TrueType® fonts

Scalable text including rotation, mirror and inverse printing

Auto real time and date functions

Auto best before date calculation and concession management

Auto incrementing & decrementing text, counters and bar codes

Hour, day of week, day of month, week of year, month of year,

year of decade and Arabic date support

Start of day, shift codes, factory, machine, line ID

### Languages

English, Arabic, Chinese (Mandarin), Danish, Dutch, Finnish, French, Hungarian, Italian, Japanese, German, Greek, Polish, Portuguese, Russian, Spanish, Swedish and Turkish

### On-Board Memory

512 MB memory, CompactFlash®

### Inputs / Outputs

Multiple inputs and outputs available. Contact Technical Support or see Service Manual for details.

### Supported Field Types

Fixed, variable (user entered), merged, database, counters, date, offsets, time, paragraph (Text Blocks)

Basic shape drawing (circles, rectangles etc.)

### External Data Communications

RS-232 point-to-point communications

Ethernet 10/100 Base TX network communications

Binary and ASCII comms protocols and Windows drivers

Host PC mode (Remote Database) using CLARiNET®

USB connectivity for job download and software updates

### Connectivity

Up to (4) printheads in master/follower mode

Group job selection function and group printer control function

### Network Control Software

CLARiNET® network management software

CLARiTY™ Configuration Manager

'Off-Line' set up and parameter storage available as standard

### Ink/Ink System

Non-toxic, suitable for food packaging

Non-pressurized, screw-in canister; 115 ml or 365 ml

Colors available: black, blue, green, orange, purple, red, yellow

### Power Supply

90-264VAC, 47-63 Hz, 140VA (max)

0.7 maximum amps required

### Air Supply

6 Bar, 90psi, dry, uncontaminated

### Operating Temperature

10°-35° C (50°-95° F)

### Weight

2340 - Boxed 12 lbs (5.4 KG); Unboxed: 8 lbs (3.6 kg)

2350/60 - Boxed: 12 lbs (5.4 kg); Unboxed: 9 lbs (4.1 kg)

### Approvals

CE/UL60950:2000 (3rd edition)



### Dimensions

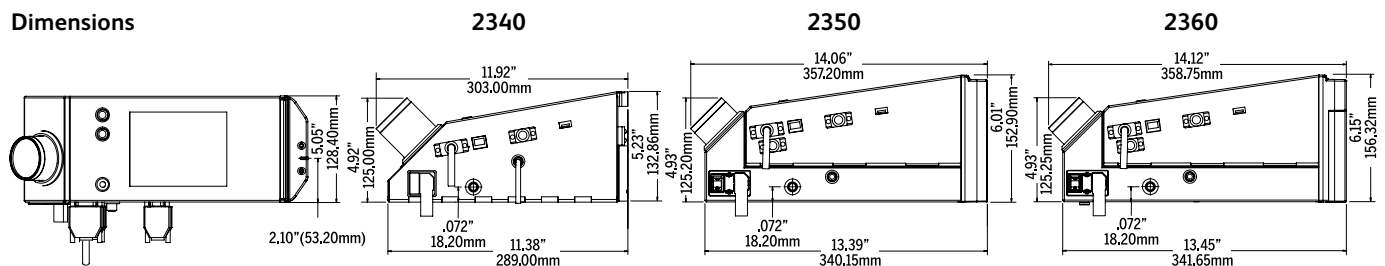

Call **65 6444 4218**

Email **marketing.singapore@videojet.com**

or visit **www.videojet.com/sg**

Videojet Technologies (S) Pte Ltd  
750 Oasis, Chai Chee Road,  
#03-20 Technopark @ Chai Chee,  
Singapore 469000.

©2014 Videojet Technologies Inc. — All rights reserved.

Videojet Technologies Inc.'s policy is one of continued product improvement.

We reserve the right to alter design and/or specifications without notice.

TrueType is a registered trademark of Apple Computer, Inc.

Part No. SL000585

2300 Spec Sheet-0114